

INSTALLATION CHECKLIST FOR GAS RANGES

1. Determine if a fuel conversion is needed

Your range will require a fuel conversion if you intend to connect to propane.

NOTE: Propane conversions must be completed by a qualified service technician (see the gas conversion section in the installation instructions that came with your range).

⚠ WARNING



Explosion Hazard

Use a new CSA International approved gas supply line.

Install a shut-off valve.

Securely tighten all gas connections.

If connected to propane, have a qualified person make sure gas pressure does not exceed 14" (36 cm) water column.

Examples of a qualified person include:

licensed heating personnel,
authorized gas company personnel, and
authorized service personnel.

Failure to do so can result in death, explosion, or fire.

2. Verify properly tightened fuel connections.

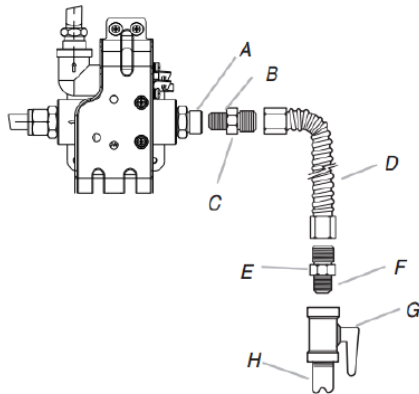

A. Pressure regulator connection fitting

B. Use Pipe-Joint compound.

C. Adapter

D. Flexible connector

E. Adapter

F. Use pipe-joint compound.

G. Manual shutoff valve

H. 1/2" (1.3 cm) or 3/4" (1.9 cm) gas pipe

Example of how to make a gas connection.

IMPORTANT: All connections must be wrench-tightened. Do not make connections to the gas regulator too tight. Making the connections too tight may crack the regulator and cause a gas leak. Do not allow the regulator to turn when tightening fittings.

3. Verify the gas regulator is "ON"

1. Locate gas pressure regulator in the back of the range.

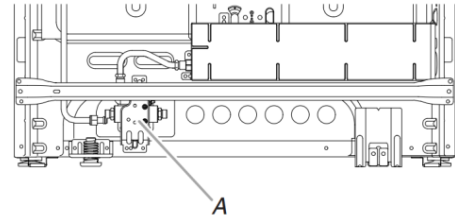

Gas pressure regulator location. Rear view of range.

IMPORTANT: Do not remove the gas pressure regulator.

2. Check that the gas pressure regulator shutoff valve is in the "ON" position.

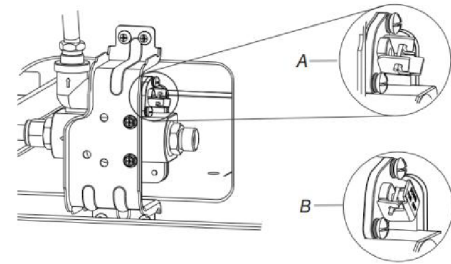

Gas regulator lever position "A. ON" and "B. OFF"

IMPORTANT: The factory default setting is the "ON" position. If the range does not work, verify that the valve is in the "ON" position.

4. Verify surface burner function

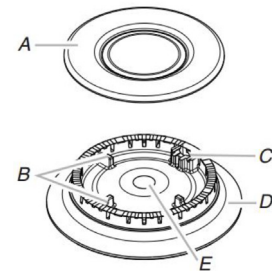

A. Burner cap

B. Alignment pins

C. Igniter

E. Burner base

F. Gas tube opening

Surface gas burner assembly

To ignite burner:

1. Push in and turn knob counter-clockwise to LITE. All surface burners will click. Only the burner with the control knob turned to LITE will produce a flame.
2. Turn knob to anywhere between High and Low. The clicking will stop.

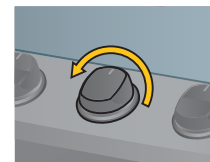

To ignite burner

USE & CARE QUICK GUIDE FOR GAS RANGES

5. General cleaning

To Clean surface burners and nozzles:

IMPORTANT: Before cleaning, make sure all controls are off and the oven and cooktop are cool. Do not use oven cleaners, bleach or rust removers.

1. Remove the surface grates.
2. Remove the burner cap from the burner base and clean according to "General Cleaning" section in user guide.
3. Clean the nozzle using a straight pin.

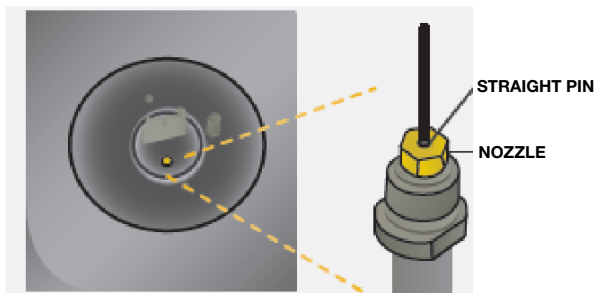

4. Clean clogged burner ports with a straight pin as shown. Do not enlarge or distort the port. Do not use a wooden toothpick. If the burner needs to be adjusted, contact a trained repair specialist.

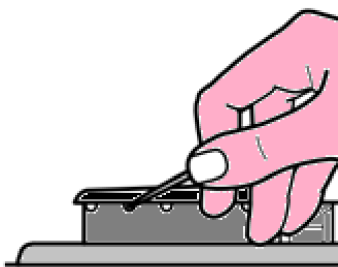

5. Replace the burner cap, making sure the alignment pins are properly aligned with the burner cap.

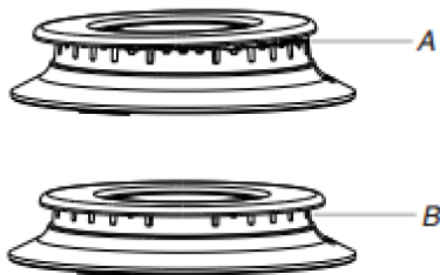

A. Incorrect
B. Correct

Properly aligned between burner and cap.

6. Replace the surface grates.
7. Turn on the burner. If the burner does not light, check cap alignment. If the burner still does not light, do not service the burner yourself. Contact a trained repair specialist.

Gas tube opening:

Gas must flow freely throughout the gas tube opening for the burner to light properly. Keep this area free of soil and do not allow spills, food, cleaning agents or any other material to enter the gas tube opening. Keep spillovers out of the gas tube by always using a burner cap.

6. LCC OPERATION (Feature only in some models)

Odors and smoke are normal when the oven is used the first few times, or when it is heavily soiled.

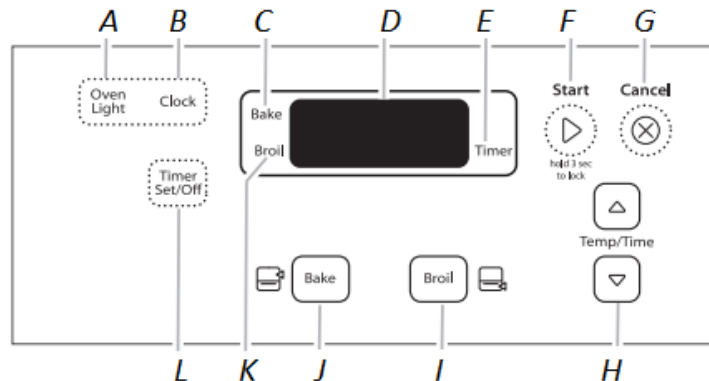

- | | |
|--------------------------|--------------------------|
| A. Oven light | G. Off/Cancel |
| B. Clock | H. Temp/time |
| C. Bake indicator light | I. Broil |
| D. Display | J. Bake |
| E. Timer indicator light | K. Broil indicator light |
| F. Start (Control lock) | L. Timer set/off |

LCC control and functions.

Basic oven operation:

- Press BAKE or BROIL to select oven function.



- Set oven temperature.



- To start oven function, press START



- To stop or cancel oven function, press CANCEL



Control lock: When the control is locked, only Clock, Oven Light and Timer Set/Off will function.

To Lock/Unlock Control: Before locking, make sure the cook functions are off. Press and hold START for 3 seconds, and "Loc" will appear on the display. Repeat to unlock. "Loc" will disappear from the display.

ASSISTANCE OR SERVICE

Before calling for assistance or service, please check "Troubleshooting". If you still need to call for help, please know the purchase date and the complete model and serial number of your appliance. This information will help us to better respond to your request.

In U.S.A.

Call the Whirlpool Customer experience Center toll free:
1-800-253-1301 or visit our website at www.whirlpool.com.