

49 1/4"

# 1 TEMPLATE

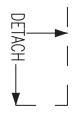
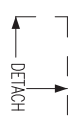

## TEMPLATE 2 - THIS SIDE IS FOR BOTTOM OF THE CABINET

**IMPORTANT**  
Read the instruction booklet for complete instructions before beginning installation. Template must be laid against the cabinet when locating the holes.

17 3/8"

### INSTRUCTIONS

(See installation booklet for complete instructions)

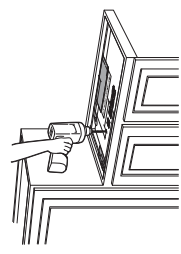

If you drill the 4 mounting holes from the bottom side of the cabinet—measure the thickness of the front rail and cut that amount of the template from the front side. Place the cut edge against the back side of the front rail and position. Drill the 4 holes 1/4" DIA. as described in the installation instruction booklet.

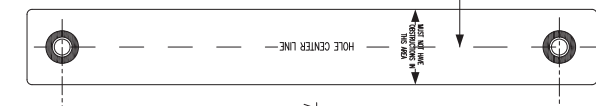
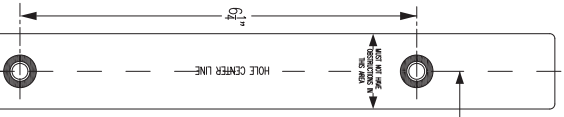
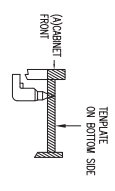

MICROWAVE SIDE B

MICROWAVE SIDE B

MICROWAVE FRONT CONTROL PANEL SIDE

MICROWAVE FRONT DOOR SIDE

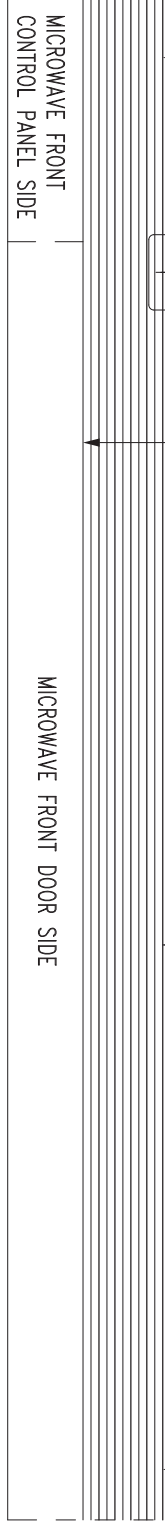

# 1 TEMPLATE

17<sup>5</sup>/<sub>8</sub>"

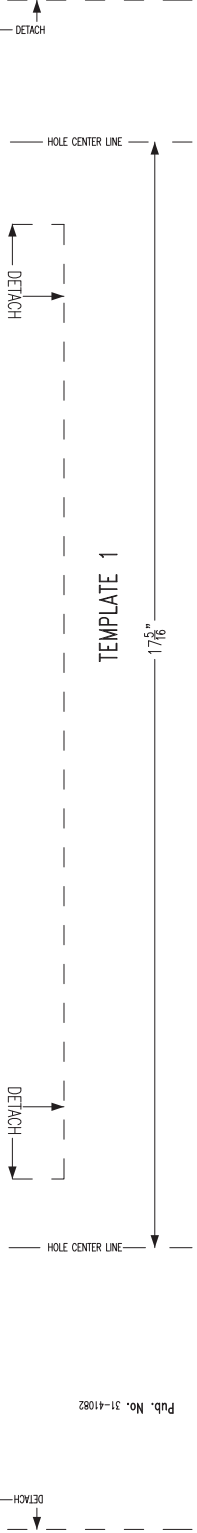

## TEMPLATE 2 - THIS SIDE IS FOR INSIDE OF THE CABINET

**IMPORTANT**  
Read the instruction booklet for complete instructions before beginning installation. Template must fit snug against the cabinet when locating the holes.

17<sup>5</sup>/<sub>8</sub>"

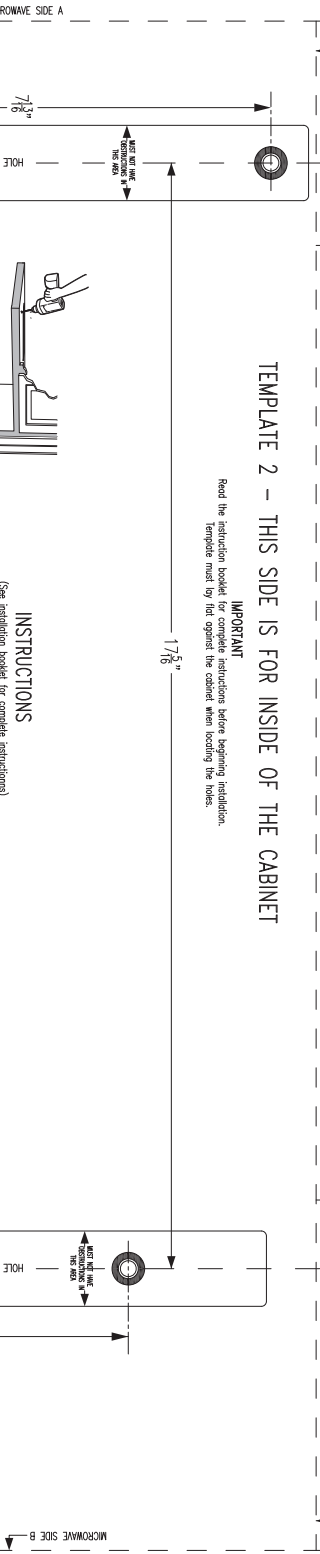

### INSTRUCTIONS

(See installation booklet for complete instructions)

If you drill the 4 mounting holes from the inside of the cabinet, please refer to the instructions in the instruction booklet. Drill the 4 holes 1/4" DIA. as described in the installation instruction booklet.

### IMPORTANT

MAKE SURE THAT THE LEFT AND RIGHT SIDES OF THIS TEMPLATE-MICROWAVE SIDE (A) OR (B)-ASSET WITH THE DESIRED, DESIRED LOCATION OF THE MOUNTED OVERLAPPING, ON WHETHER YOU CHOOSE TO DRILL FROM INSIDE THE CABINET OR FROM THE EXTERIOR SIDE OF THE CABINET. THE MICROWAVE SIDE (A) OR MICROWAVE SIDE (B) WILL INDICATE THE LOCATION OF THE SIDES OF THE MOUNTED OPEN.

MICROWAVE FRONT DOOR SIDE

MICROWAVE FRONT CONTROL PANEL SIDE

MICROWAVE FRONT DOOR SIDE

MICROWAVE FRONT CONTROL PANEL SIDE