

GIE18ISH

GE Appliances ENERGY STAR® 18.2 Cu. Ft. Top-Freezer Refrigerator

DIMENSIONS AND INSTALLATION INFORMATION (IN INCHES)

OVERALL DIMENSIONS	Height to top of hinge (in.) A	66-5/8
	Height to top of case (in.) B	65-7/8
	Case depth without door (in.) C	28-3/8
	Case depth less door handle (in.) D	32-1/8
	Case depth with door handle (in.) E	34-1/2
	Depth with fresh food door open 90° (in.) F	60
	Width (in.) G	29-1/2
	Width with door open 90° with door handle (in.) H	32-3/8
AIR CLEARANCES	Each side (in.)	1/8
	Top (in.)	1
	Back (in.)	2

FRONT VIEW

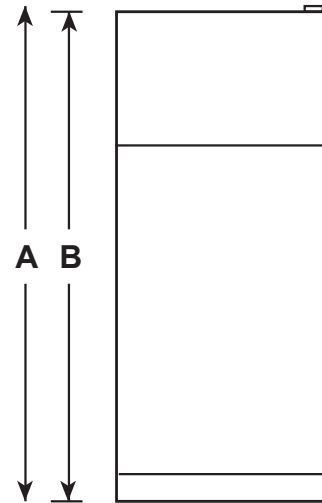

TOP VIEW

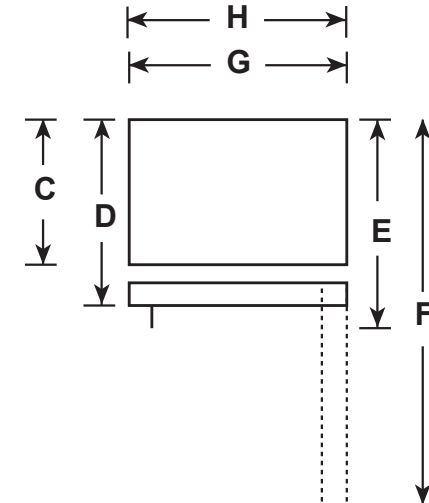

For answers to your Monogram, GE Café™ Series, GE Profile™ Series or GE Appliances product questions, visit our website at geappliances.com or call GE Answer Center® Service, 800.626.2000.



Listed by
Underwriters
Laboratories



As an ENERGY STAR® partner, GE has determined that this product meets the ENERGY STAR guidelines for energy efficiency.

GIE18ISH

GE Appliances ENERGY STAR® 18.2 Cu. Ft. Top-Freezer Refrigerator

FEATURES AND BENEFITS

2014 ENERGY STAR® qualified

29-1/2" wide

Upfront dual temperature controls - Separate controls for the freezer and fresh food compartments regulate interior temperatures

Adjustable glass shelves - A variety of shelf configurations provide additional options for food storage

Factory-installed icemaker - Refrigerator comes ready to automatically create ice

Snack drawer - Conveniently stores favorite foods and allows for quick, easy access

Gallon door storage - Larger items are easily accommodated in the door

Clear drawers - Transparent drawers make finding your favorite items quick and easy

Adjustable wire freezer shelf - Easily adjusts between two positions to accommodate items of all shapes and sizes

Spillproof freezer floor - Seamless design of the freezer floor wipes up easily for quick cleanup

Model GIE18ISHSS - Stainless steel

